



# 6015 & 578DRO Digital Readout

*Please Read Carefully!*

### Parts List:

Part	Description	Quantity
6015	Digital Readout unit .....	1
6015A	DRO Mount .....	1
6015B	Bracket Mount w/hdw., bagged. ....	1
BUSH002	5/8" OD x 1/4" long spacer. ....	3
BUSH004	5/8" OD x 5/8" long spacer. ....	2
5521	knob. ....	2
HB030	1" bolt .....	2
MF031	1/4-20 x 2-1/4" flathead screw. ....	1
<i>Parts below are used for 578DRO only:</i>		
NUT010A	locknut .....	1
WB002	washer. ....	2
HB059	1/4-20 x 2-1/2" bolt .....	1

### BEFORE BEGINNING

Identify and verify that you have all the parts listed. Read thru the instructions at least once, familiarizing yourself with the parts and process before proceeding. You'll need a #3 Phillips screwdriver for assembly to our 6000-6004 Horizontal Router Table. Note: You can't use the digital readout if you have an Angle-Ease model setup with the bit tilting down.

### IF YOU HAVE A 576-578

You'll need two 7/16" wrenches for assembly, plus a 1/4" drill. As you face the front of the Horizontal Router Table/Plate, drill 1/4" hole in the upper left (*or right - see below*) hand corner of the plate 5/16" down from the top and 1-1/16" in from the edge of the plate. *See fig. 2.*

### ASSEMBLY

Get the Digital Readout (**6015**) and read thru the *iGAGING DigiMAG Remote Readout* instructions to familiarize yourself with its parts list. The Slider Sensor Unit (**3**) comes pre-installed on the Digital Scale Beam (**4**) which has two holes drilled in it. The Connection Cable (**2**) of the Slider Sensor Unit should be sticking out towards the back of the Horizontal Router Table when assembly is complete.

Install a 1/4" spacer (**BUSH002**) on both of the 1" bolts (**HB030**). From the back of the Digital Scale Beam, insert the bolts thru the holes at each end and screw a knob (**5521**) on the end of each bolt. Slide the heads of the bolts into the T-slot of one of the 24" Double Tracks on your Horizontal Router Table, keeping the 1/4" spacer between the Double Track and the back of the Digital Scale Beam. Position the beam where desired on the track for now and tighten the knobs. *See fig. 3 & 4.*

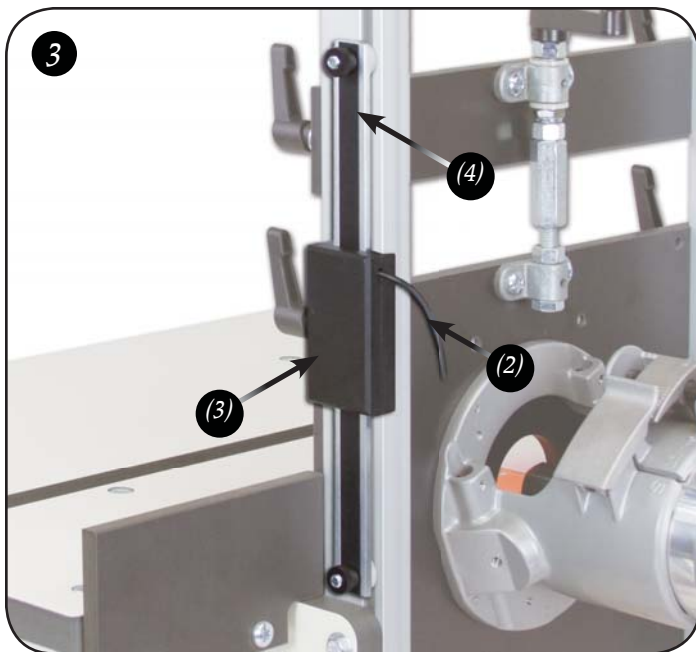
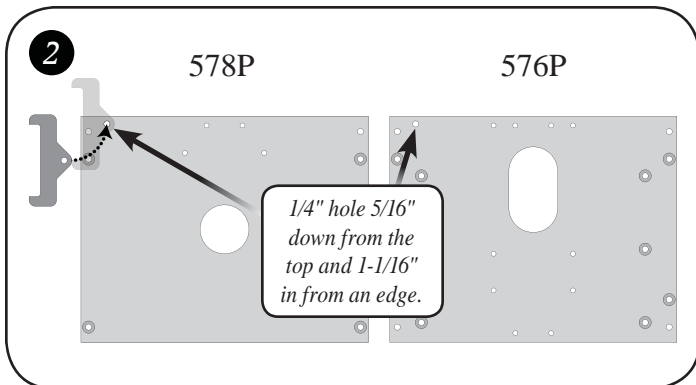

## ATTACH 6015A TO ROUTER PLATE

Attach the DRO Mount (**6015A**) to back of the router plate of your Horizontal Router Table, following one of the next two instructions that cover your Horizontal Router Table model.

### INSTALL 6015A ON THE 6000-6004

Insert the 2-1/4" flathead screw (**MF031**) thru the countersunk hole in the DRO Mount (**6015A**) and install one 1/4" spacer (**BUSH002**) and two 5/8" spacers (**BUSH004**) on it. Press the "ears" of the DRO Mount over the body of the Slide Sensor Unit and, from the back of the router plate, fasten the screw/spacers/DRO Mount to the threaded hole in the upper right or left hand corner of the plate. *See fig. 5.*

### INSTALL 6015A ON THE 576-578

Install a washer (**WB002**) on the 2-1/2" bolt (**HB059**), insert it thru the countersunk hole in the DRO Mount (**6015A**) and install one 1/4" spacer (**BUSH002**) and two 5/8" spacers (**BUSH004**) on it. Press the "ears" of the DRO Mount over the body of the Slide Sensor Unit and, from the back of the router plate, fasten the bolt/spacers/DRO Mount to the hole you drilled in the upper corner of the router plate, using a second washer and a locknut (**NUT010A**) to fasten it to the plate.

## MOUNT THE DIGITAL DISPLAY UNIT

The Digital Display Unit (**1**) can be mounted on any magnetic surface using the magnets in the back of it. We also supply a Bracket Mount (**6015B**) that has the Stand Base for Display Unit (**8**), plus other hardware, pre-attached to it. Install a 3/8" spacer (**BUSH5038**) on the thumb screw (**5500**), insert the thumb screw thru the hole in the angle bracket attached to the Bracket Mount and start an oval nut (**5750B**) on the end of it. Slid the oval nut into the T-slot on the side or front of the 24" Double Track and tighten the thumb screw. *See fig. 6.*

## USING THE DIGITAL READOUT

You will have extra hardware left over (**5, 6, 7 & 9**) from the **iGAGING** parts list. This is the manufacturers mounting hardware that we don't use. Follow the **iGAGING** instructions regarding the Display Functions. Install the batteries in the back of the Digital Display Unit (**10 - rear view**) to begin using it.

Loosen and slide the Digital Scale Beam to any position along the length of the Double Track to take advantage of the full adjustment range of the Horizontal Router Table. Make sure the knobs are tightened before making any height adjustments or the reading will be faulty.

©Copyright WOODHAVEN INC. 11/10/10  
(800) 344-6657 or [www.woodhaven.com](http://www.woodhaven.com)

